

**3123RL** WEIGHT 12881 LENGTH 35' 1"

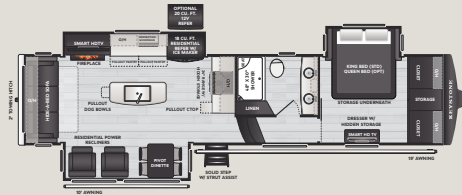

**3231CK** WEIGHT 13169 LENGTH 37' 5"

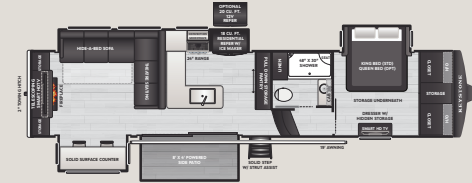

**3532SP** WEIGHT 14405 LENGTH 39' 2"

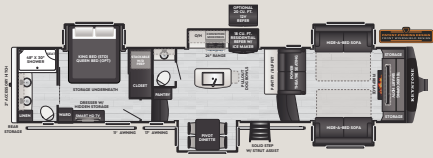

**3761FL** WEIGHT 14951 LENGTH 41' 0"

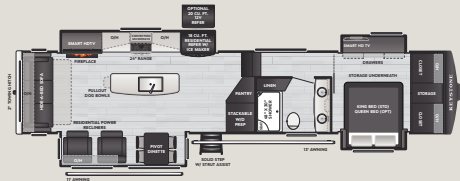

**3781RL** WEIGHT 13790 LENGTH 41' 0"

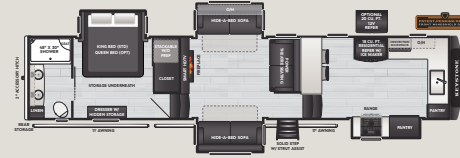

**3795FK** WEIGHT 14030 LENGTH 39' 11"

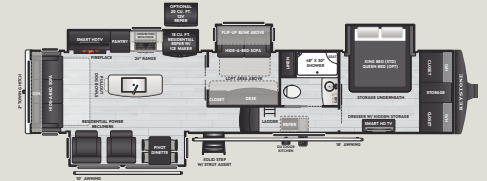

**3857BR** WEIGHT 14668 LENGTH 40' 11"

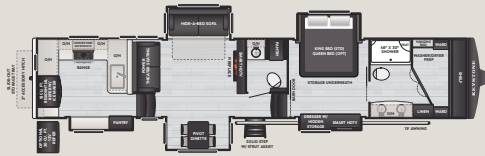

**3901RK** WEIGHT 15063 LENGTH 42' 4"

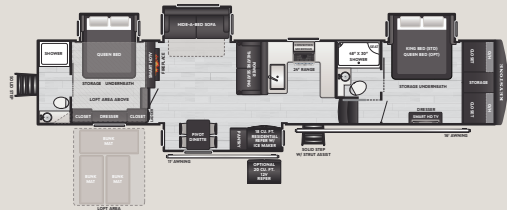

**3915TB** WEIGHT 15222 LENGTH 43' 0"

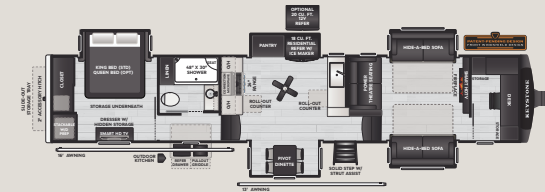

**3941FO** WEIGHT 15644 LENGTH 42' 7"



## STANDARD FEATURES & OPTIONS

### INTERIOR

- ◆ La-Z-Boy® Furniture Package
- ◆ Manhattan Maple Interiors w/ Birch & White Accents
- ◆ Hardwood Cabinet Drawers, Doors, Stiles and Window Treatments
- ◆ Soft Close Cabinet Drawers and Doors
- ◆ Solid Surface Countertops
- ◆ Starlink Prep
- ◆ Belair Vinyl Flooring w/ 7-Year Cold Cracking Warranty
- ◆ Island Design w/ built in Dog Dishes (SELECT MODELS)
- ◆ Waterfall Sink with Added Attachments
- ◆ Dishwasher Prep (Select Models)
- ◆ 24" Furrion Stove w/ Matching Stainless Steel Drawer
- ◆ Stainless Steel Convection Microwave
- ◆ 18 cu. ft. Residential Refrigerator w/ Ice Maker (Opt. 20 cu. ft. 12V Refrigerator w/ Ice Maker)
- ◆ 50" Smart TV in the Living Room & 32" in Bedroom
- ◆ JBL® Stereo with Mizone Control & Subwoofer
- ◆ Central Vacuum with Toe Kick
- ◆ Adjustable Shelving in Pantry
- ◆ Flip Up Jewelry Box Storage Built into Bedroom Dresser Top
- ◆ Sliding Silverware Storage Built into Dinette Table
- ◆ Dual Suite Front Closet w/ Washer/Dryer Prep
- ◆ Bathroom Storage w/ Built-In Spot for Hair Dryer & Curling Iron
- ◆ Dual Sided Memory Foam Mattress
- ◆ 6'6" Main Floor Slide Box Height

### EXTERIOR

- ◆ Square Frameless Windows w/ Built in Reflective Shades
- ◆ Fibrogloss™ High-Gloss Sidewalls
- ◆ MaxTurn™ Technology Front Cap
- ◆ 30" X 78" Oversized Entry Door
- ◆ MORryde Telescoping Entry Door Rail
- ◆ MORryde Strut Assist Flip Down Solid Steps
- ◆ Insulated Baggage Doors
- ◆ Split Baggage Doors on Off Door Side (SELECT MODELS)
- ◆ 3K lbs. Tow Hitch (3123RL, 3231CK, 3532SP, 3781RL, 3857BR)
- ◆ 300 lbs. Accessory Hitch (3761FL, 3795FK, 3901RK, 3941FO)
- ◆ Zero Degree Tested for 48 Hours
- ◆ Built in Water Filtration
- ◆ Exterior Lighting Package
- ◆ 220 Watt Future Solutions Solar Panel w/30 AMP Control
- ◆ 16 Gal Gas/Electric Hot Water Heater
- ◆ Dual Battery Box
- ◆ Triple 15k BTU Power Saver A/C's
- ◆ 16,500 BTU Heat Pump on Main A/C
- ◆ Dynamic Exterior Graphics (5 Year Warranty)
- ◆ MORryde CRE3000 Suspension
- ◆ MORryde Rubber Pin Box
- ◆ Upgraded 7K lb. Dexter® Gladiator Axles (8K lb. on 3761FL, 3901RK, 3915TB, 3941FO)
- ◆ 17.5" wheels w/ H-Rated Tires

### OPTIONS

- ◆ Legacy Package: Disc Brakes, Power Cord Reel, Starlink Roof Panel, Winegard Router, Furrion Side/Rear Cameras, Surge Protector, Electric Dump Valves, Rear Fiberglass Cap (SELECT MODELS)
- ◆ Full Body Paint Options Available: NEW Glacier, Volcano, Sterling, Cobalt
- ◆ Dual Pane Frameless Windows
- ◆ Solar Flex Discover
- ◆ Solar Flex Outlast Extreme
- ◆ DragonFly® Energy Lithium-ion Heated Batteries
- ◆ MORryde Independent Suspension
- ◆ Generator Prep
- ◆ Onan Marque Gold 5.5kw LP Generator
- ◆ Slide-Out Awning Toppers
- ◆ Stackable Washer/Dryer
- ◆ Queen Bed



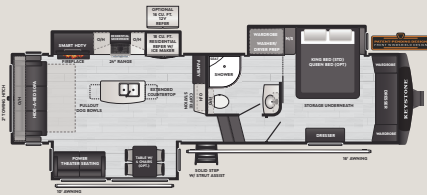

**295RL** WEIGHT 11692 LENGTH 34' 0"

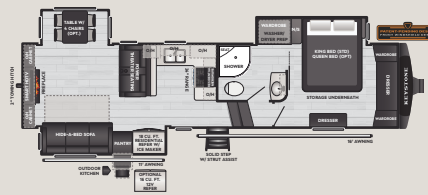

**311RD** WEIGHT 11770 LENGTH 35' 0"

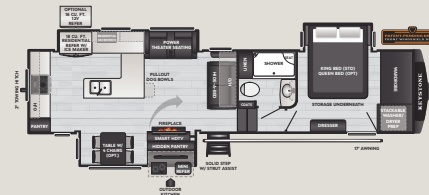

**325RK** WEIGHT 12245 LENGTH 36' 7"

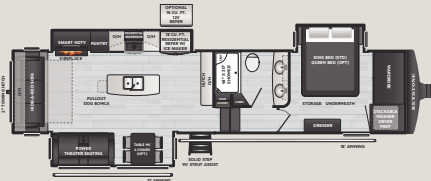

**331RL** WEIGHT 12217 LENGTH 37' 4"

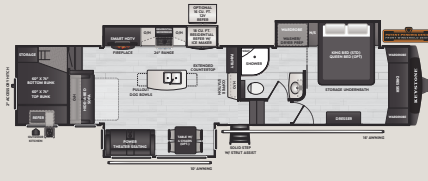

**351BH** WEIGHT 13278 LENGTH 39' 0"

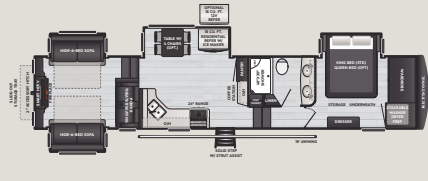

**373RD** WEIGHT 13399 LENGTH 41' 4"

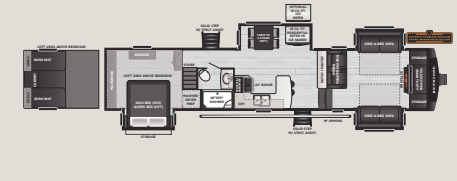

**377FL** WEIGHT 13513 LENGTH 41' 11"

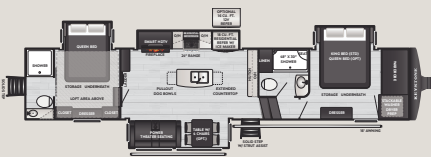

**381TB** WEIGHT 14451 LENGTH 42' 5"

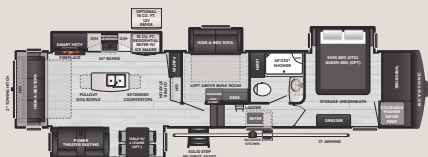

**385BR** WEIGHT 13794 LENGTH 40' 9"



**389BH** WEIGHT 13968 LENGTH 40' 5"

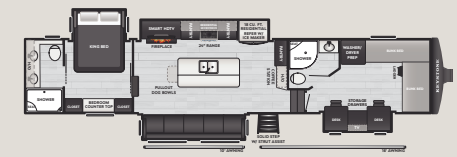

**397FB** WEIGHT 14695 LENGTH 43' 0"



## STANDARD FEATURES & OPTIONS

### INTERIOR

- ◆ La-Z-Boy® Furniture Package
- ◆ Manhattan Maple Interiors w/ Birch & White Accents
- ◆ Hardwood Cabinet Drawers, Doors, Stiles and Window Treatments
- ◆ Soft Close Cabinet Drawers and Doors
- ◆ Solid Surface Countertops
- ◆ Starlink Prep
- ◆ Belair Vinyl Flooring w/ 7-Year Cold Cracking Warranty
- ◆ Island Design w/ built in Dog Dishes (SELECT MODELS)
- ◆ Waterfall Sink with Added Attachments
- ◆ Dishwasher Prep (Select Models)
- ◆ 24" Furrion Stove w/ Matching Stainless Steel Drawer
- ◆ Stainless Steel Convection Microwave
- ◆ 18 cu. ft. Residential Refrigerator w/ Ice Maker (Opt. 20 cu. ft. 12V Refrigerator w/ Ice Maker)
- ◆ 50" Smart TV in the Living Room & 32" in Bedroom
- ◆ JBL® Stereo with Mizone Control & Subwoofer
- ◆ Central Vacuum with Toe Kick
- ◆ Adjustable Shelving in Pantry
- ◆ Flip Up Jewelry Box Storage Built into Bedroom Dresser Top
- ◆ Sliding Silverware Storage Built into Dinette Table
- ◆ Dual Suite Front Closet w/ Washer/Dryer Prep
- ◆ Bathroom Storage w/ Built-In Spot for Hair Dryer & Curling Iron
- ◆ Dual Sided Memory Foam Mattress
- ◆ 6'6" Main Floor Slide Box Height

### EXTERIOR

- ◆ Square Frameless Windows w/ Built in Reflective Shades
- ◆ Fibrogloss™ High-Gloss Sidewalls
- ◆ MaxTurn™ Technology Front Cap
- ◆ 30" X 78" Oversized Entry Door
- ◆ MORryde Telescoping Entry Door Rail
- ◆ MORryde Strut Assist Flip Down Solid Steps
- ◆ Insulated Baggage Doors
- ◆ Split Baggage Doors on Off Door Side (SELECT MODELS)
- ◆ 3K lbs. Tow Hitch (3123RL, 3231CK, 3532SP, 3781RL, 3857BR)
- ◆ 300 lbs. Accessory Hitch (3761FL, 3795FK, 3901RK, 3941FO)
- ◆ Zero Degree Tested for 48 Hours
- ◆ Built in Water Filtration
- ◆ Exterior Lighting Package
- ◆ 220 Watt Future Solutions Solar Panel w/30 AMP Control
- ◆ 16 Gal Gas/Electric Hot Water Heater
- ◆ Dual Battery Box
- ◆ Triple 15k BTU Power Saver A/C's
- ◆ 16,500 BTU Heat Pump on Main A/C
- ◆ Dynamic Exterior Graphics (5 Year Warranty)
- ◆ MORryde CRE3000 Suspension
- ◆ MORryde Rubber Pin Box
- ◆ Upgraded 7K lb. Dexter® Gladiator Axles (8K lb. on 3761FL, 3901RK, 3915TB, 3941FO)
- ◆ 17.5" wheels w/ H-Rated Tires

### OPTIONS

- ◆ Legacy Package: Disc Brakes, Power Cord Reel, Starlink Roof Panel, Winegard Router, Furrion Side/Rear Cameras, Surge Protector, Electric Dump Valves, Rear Fiberglass Cap (SELECT MODELS)
- ◆ Full Body Paint Options Available: NEW Glacier, Volcano, Sterling, Cobalt
- ◆ Dual Pane Frameless Windows
- ◆ Solar Flex Discover
- ◆ Solar Flex Outlast Extreme
- ◆ DragonFly® Energy Lithium-ion Heated Batteries
- ◆ MORryde Independent Suspension
- ◆ Generator Prep
- ◆ Onan Marque Gold 5.5kw LP Generator
- ◆ Slide-Out Awning Toppers
- ◆ Stackable Washer/Dryer
- ◆ Queen Bed

