

MONTANA

FIFTH WHEELS

SCAN FOR MORE INFO

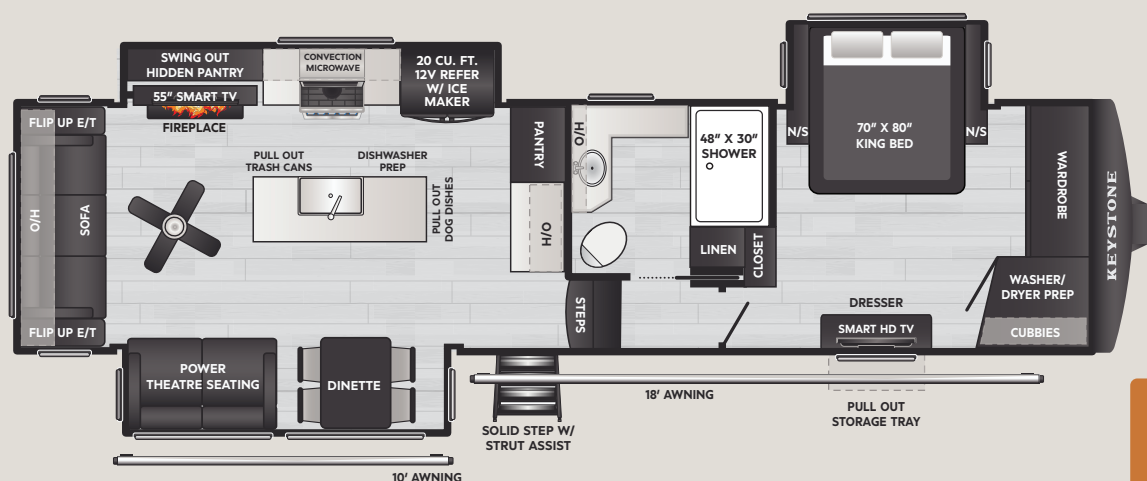
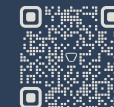

NEW

3100RL

WEIGHT 15345

LENGTH 35' 11"



DISCLAIMER: Product information is as accurate as possible as of the date of publication of this publication. All features, floor plans, and specifications in this publication are subject to change without notice. Please also consult Keystone's web site at www.keystonerv.com for more current product information and specifications. Tow Vehicle Disclaimer. CAUTION: Owners of Keystone recreational vehicles are solely responsible for the selection and proper use of tow vehicles. All customers should consult with a motor vehicle manufacturer or their dealer concerning the purchase and use of suitable tow vehicles for Keystone products. Keystone disclaims any liability or damages suffered as a result of the selection, operation, use or misuse of a tow vehicle. KEYSTONE'S LIMITED WARRANTY DOES NOT COVER DAMAGE TO THE RECREATIONAL VEHICLE OR THE TOW VEHICLE AS A RESULT OF THE SELECTION, OPERATION, USE OR MISUSE OF THE TOW VEHICLE. *Length is defined as the distance from the centerline of hitch pin/coupler to rear bumper of trailer. ** Fresh water capacity includes water heater. Please review owner's manual prior to purchase for more information on service warranties, extended use, towing and maintenance. Owner's manuals can be found at keystonerv.com.

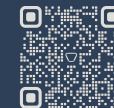

STANDARD FEATURES & OPTIONS

INTERIOR

- ♦ 101" Wide-Body Construction
- ♦ 35K BTU Furnace
- ♦ 3-ACs (18.5K Furrion Chill Cube Main, 13.5K AC 2nd and 3rd)
- ♦ Dishwasher & Washer/Dryer Prep
- ♦ Jewelry Box & Vanity Mirror with Hidden Safe
- ♦ 70" x 80" King Bed
- ♦ Wrap-around solid surface nightstands
- ♦ Stained/Painted Hardwood Cabinet & Drawer Construction
- ♦ Soft Close Drawers and Doors throughout
- ♦ 70" x 80" King Bed
- ♦ 65" 4K Smart TV in Living Room
- (SELECT FLOORPLANS)
- ♦ 40" 4K Smart TV in Bedrooms
- ♦ Multi-Functional "Deskette"
- ♦ Solid Surface Countertops
- ♦ Solid Surface Backsplash
- ♦ Solid Surface Water Fall Island
- ♦ Dual Pull out Kitchen Trash Cans
- ♦ Hidden TV Storage with adjustable shelving and pull-out drawers
- ♦ Adjustable shelves in full pantry
- ♦ Integrated USB/USB-c outlets in Kitchen, living room and bedroom
- ♦ Heat Vents in Cabinet Bases
- ♦ Dedicated Trash Can storage in Kitchen
- ♦ Freestanding 4-Burner Range W/ 3.7 Cu. Ft. Oven
- ♦ 30" Stainless Steel OTR Convection microwave
- ♦ 20 Cu. Ft. 12V French Door Refrigerator

EXTERIOR

- ♦ Curt TCS (Touring Coil Spring) Suspension
- ♦ Curt Anti-Lock Braking System
- ♦ Curt Helux Pin Box
- ♦ 17.5" Rims and "H" Load Range Tires
- ♦ Composite Exterior Sidewalls
- ♦ Hydraulic 6 Point Leveling
- ♦ Industry Leading pass-through storage with dual action slide tray
- ♦ Customizable dual rear storage trays
- ♦ Exterior slide out 50" 4K Smart TV
- ♦ Power Cord Reel
- ♦ Fully Contained Convenience Center
- ♦ Electric Dump Valves,
- ♦ Full unit water Manifold system,
- ♦ Water filtration,
- ♦ Starlink Prep
- ♦ Redundant Exterior Slide-Out and Awning Controls
- ♦ Dual Campside Awnings
- ♦ Heated/Enclosed Underbelly
- ♦ 12V Tank Pads

OPTIONS

- ♦ Full Body Paint (Frontier Gold)
- ♦ Dual Pane Windows
- ♦ Generator Ready
- ♦ Generator – 5.5K LP (Gen Ready Req.)
- ♦ Washer and Dryer
- ♦ Slide Awning Package
- ♦ Solar Flex Protect (mandatory unless upgrading to Discover or Outlast)
- ♦ Solar Flex Discover
- ♦ Solar Flex Outlast Extreme
- ♦ 2-100ah Dragonfly Energy Heated Lithium Batteries